

32mm dia x 450mm long epoxy coated smooth dowel bars grouted into holes with epoxy resin, Note 2

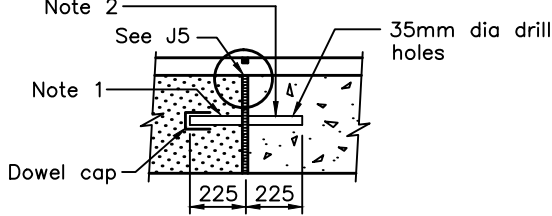

**SECTION A-A
EXPANSION JOINT**

32mm dia x 450mm long epoxy coated smooth dowel bars grouted into holes with epoxy resin, Note 2

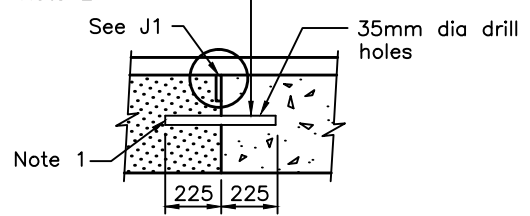

**SECTION B-B
CONTRACTION JOINT**

15mm dia epoxy coated deformed tie bars grouted into holes with epoxy resin at 600mm centres, Note 2

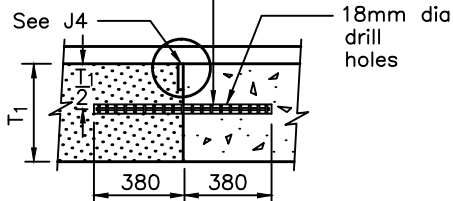

**SECTION C-C
LONGITUDINAL JOINT**

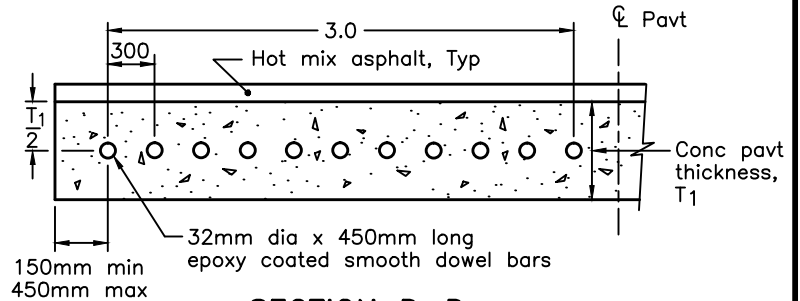

SECTION D-D

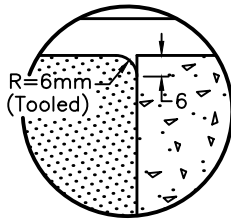

**J1, CONTRACTION JOINT
J4, LONGITUDINAL JOINT**

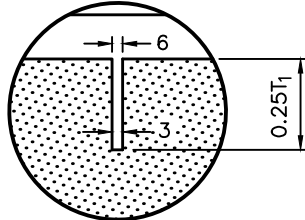

J2, CONTRACTION JOINT

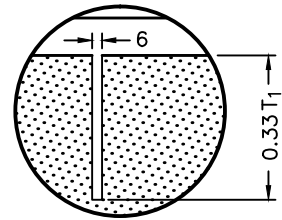

**J3
LONGITUDINAL JOINT**

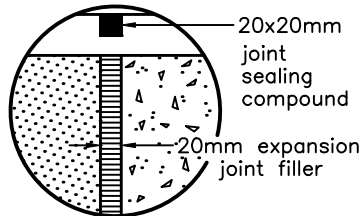

J5, EXPANSION JOINT

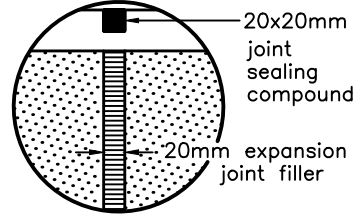

J6, TRANSVERSE EXPANSION JOINT

NOTES:

- 1 The free end of dowel bars shall be coated with an approved bond breaking material immediately prior to placing concrete.
 - 2 The epoxy resin shall envelop the bar within the drill hole and shall be set prior to placing the concrete.
- A This standard to be read in conjunction with OPSD 560.010.
 B Grout retention disks shall be used on all bars.
 C All dimensions are in millimetres unless otherwise shown.

LEGEND:

- New concrete
- T_1 = Thickness of concrete

ONTARIO PROVINCIAL STANDARD DRAWING

Nov 2018 Rev 2

COMPOSITE PAVEMENT
 FULL DEPTH CONCRETE SLAB REPAIR
 JOINT DETAILS



OPSD 560.030