

SECTION A-A

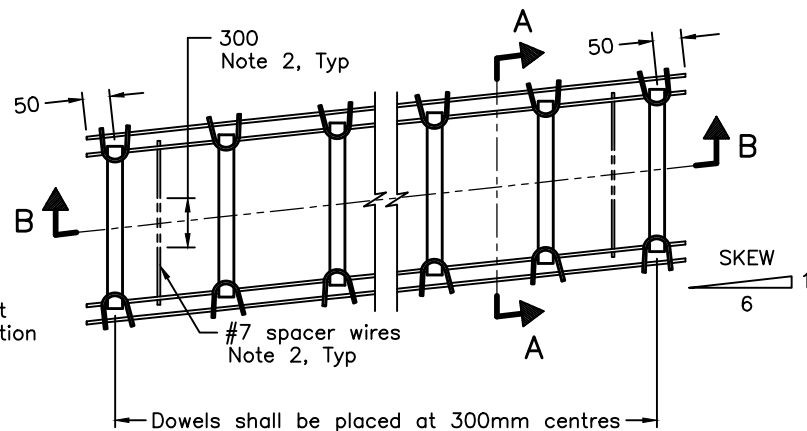

PLAN

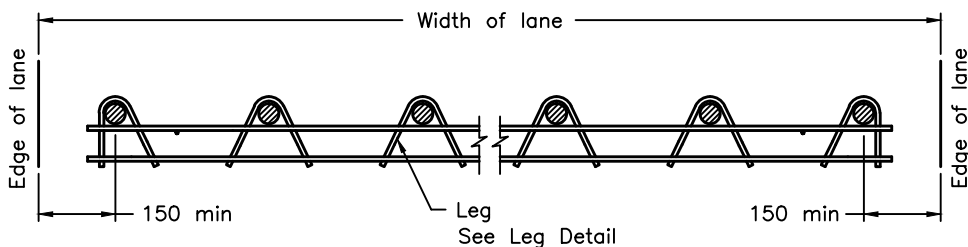

SECTION B-B

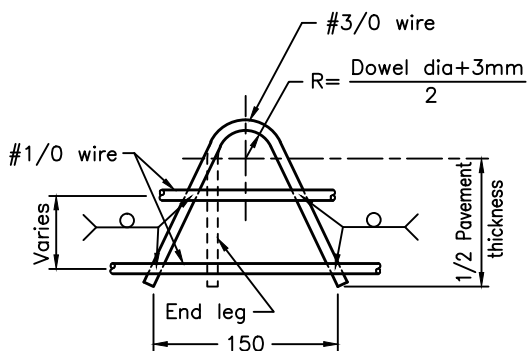

LEG DETAIL

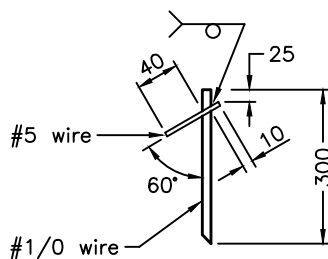

STAKE DETAIL

NOTES:

- 1 A minimum of 3 stakes shall be uniformly spaced per side per lane.
 - 2 Spacer wire shall be cut in two places and the mid section removed after staking assembly is in position. Section removed shall be a minimum length of 300mm.
 - 3 Arc or resistance spot weld, alternate ends of adjacent dowels only, top or bottom of dowel bar.
- A At bridge approaches the skew shall match the approach slab skew.
- B Load transfer device shall be shop coated with RC-250, Tectyl 506, or Protec 6116-DS Amber.
- C Load transfer devices not required in shoulders or gore areas.
- D All dimensions are in millimetres unless otherwise shown.

ONTARIO PROVINCIAL STANDARD DRAWING

Nov 2017 Rev 3

**LOAD TRANSFER DEVICE
SKEWED CONTRACTION JOINT
CONCRETE OR COMPOSITE PAVEMENT**



OPSD 552.050