

ANCHORAGE DETAIL
SECTION A-A

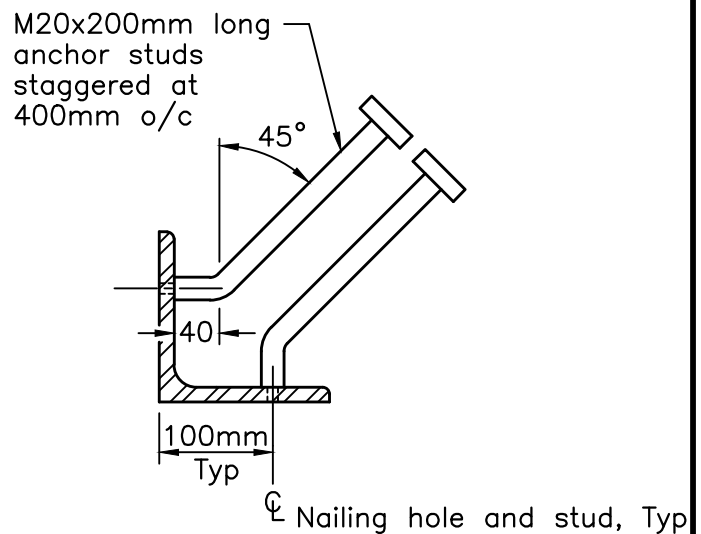

ALTERNATIVE ANCHORAGE DETAIL
SECTION A-A

NOTES:

- 1 The length of L150x150x13mm shall be as specified.
- A All steel shall be according to CSA G40.21, Grade 300W.
- B Cutwater shall be hot dip galvanized after fabrication as specified.
- C Welding shall be of a low hydrogen classification and according to CSA W59 with E480xx electrodes.
- D Anchor studs shall be attached using fusion weld process.
- E All dimensions are in millimetres unless otherwise shown.

ONTARIO PROVINCIAL STANDARD DRAWING

Apr 2022

Rev 2

PIERS
CUTWATER ASSEMBLY



OPSD 3290.100