

## ALTERNATIVES

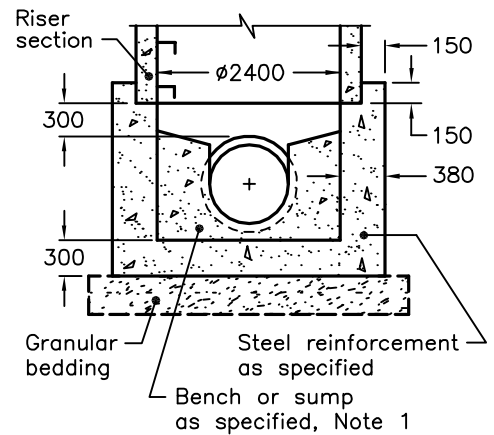

**A CAST-IN-PLACE BASE**

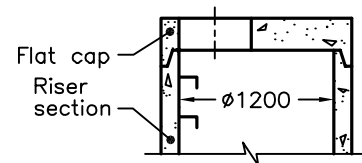

**B 1200mm PRECAST FLAT CAP**

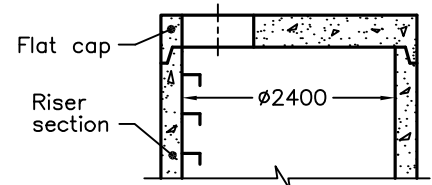

**C 2400mm PRECAST FLAT CAP**

### NOTES:

- 1 For sump detail, see OPSD 701.010.
- A Granular backfill shall be placed to a minimum thickness of 300mm all around the maintenance hole.
- B Precast concrete components shall be according to OPSD 701.030, 701.031, 701.060, 701.061, 703.013, 703.023, 706.030 and 706.031.
- C Structures exceeding 5.0m in depth shall include safety platform according to OPSD 404.020.
- D Pipe support shall be according to OPSD 708.020.
- E For benching and pipe opening details, see OPSD 701.021.
- F For adjustment unit and frame installation, see OPSD 704.010.
- G All dimensions are nominal.
- H All dimensions are in millimetres unless otherwise shown.

ONTARIO PROVINCIAL STANDARD DRAWING

Nov 2014 | Rev | 5

**PRECAST CONCRETE  
MAINTENANCE HOLE**  
2400mm DIAMETER



**OPSD 701.013**