

PLAN

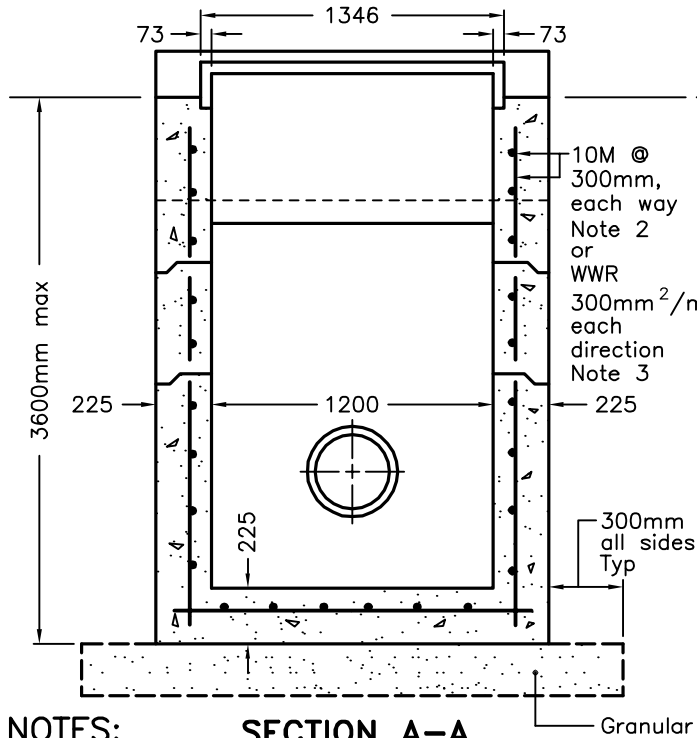

SECTION A-A

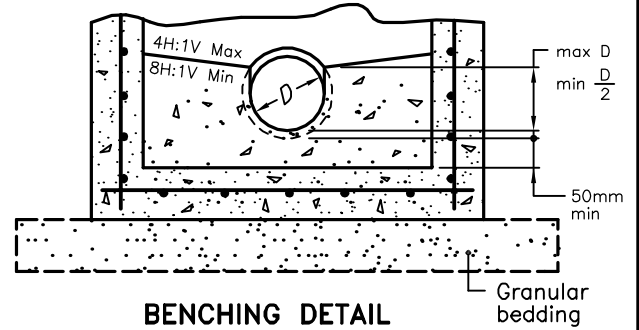

BENCHING DETAIL

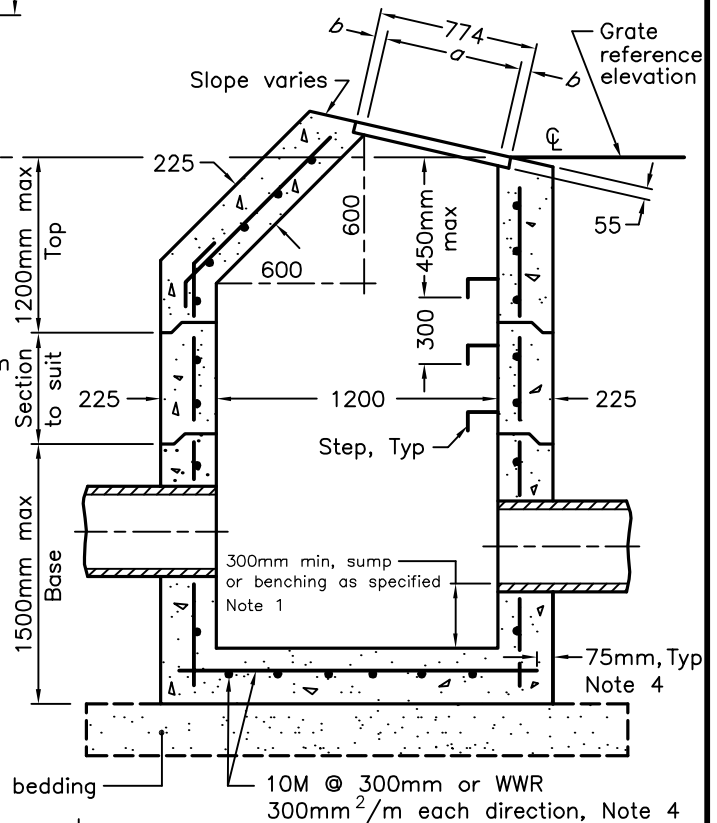

SECTION B-B

NOTES:

- 1 The sump is measured from the lowest invert. Benching as shown in Benching Detail.
 - 2 Lap horizontal 10M rebar 300mm. Laps shall be placed at corners.
 - 3 Lap horizontal wires 300mm or weld. Welds to develop 75% of yield strength of wire. Laps or welds shall be placed at corners.
 - 4 End rebar or WWR in base 75mm from outside face of wall.
- A Where inlet is placed across ditch and is accessible to vehicular traffic, grating slope shall be 6H:1V or flatter.
- B Granular backfill shall be placed a minimum thickness of 300mm all around the ditch inlet maintenance hole.
- C Concrete for benching shall be 30MPa.
- D Benching slope and height shall be as specified.
- E Grating shall be according to OPSD 403.010.
- F Steps shall be according to OPSD 405.010 or 405.020.
- G Maximum pipe size: straight through—1200mm dia; right angle pipes—700mm diameter.
- H Pipe support shall be according to OPSD 708.020.
- I Centre reinforcing in walls ± 35 mm. All other reinforcing shall have a minimum cover of 25mm.
- J All dimensions are nominal.
- K All dimensions are in millimetres unless otherwise shown.

Opening Dimensions			
Type	Slope	a	b
	B	2H:1V	670
3H:1V		632	71
4H:1V		618	78
6H:1V		608	83
HOR		600	87

ONTARIO PROVINCIAL STANDARD DRAWING

Nov 2014 Rev 3

PRECAST CONCRETE
DITCH INLET MAINTENANCE HOLE – TYPE A
1200 x 1200mm



OPSD 702.040