

**PLAN**

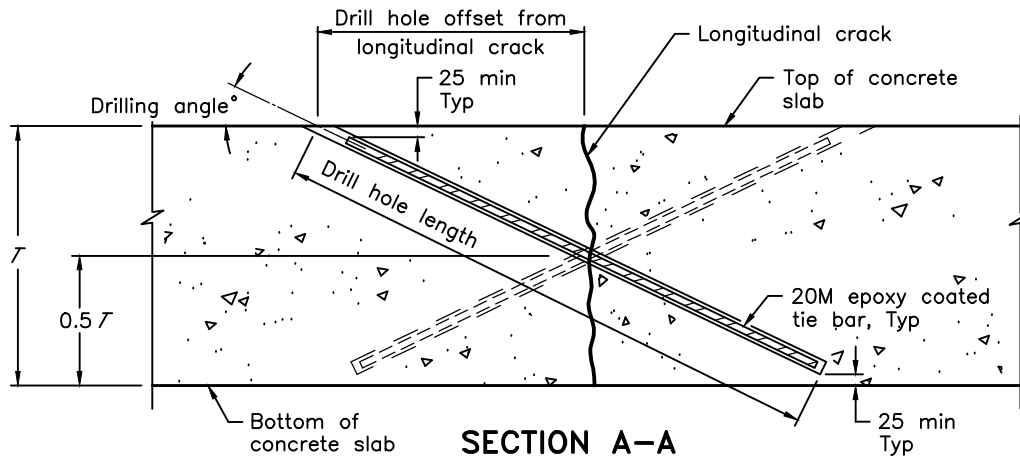

**SECTION A-A**

Cross-Stitching Drill Hole and Tie Bar Requirements				
$\tau$	Drilling Angle	Drill Hole Offset from Longitudinal Crack	Drill Hole Length	Length of Tie Bar
200	35	140	280	220
210	35	145	300	240
220	35	150	310	250
230	35	155	330	270
240	35	160	350	290
250	35	170	370	310
260	35	175	380	320
270	35	180	400	340
280	35	190	420	360
290	35	195	430	370
300	45	140	360	310
310	45	145	380	330
320	45	150	390	340
330	45	155	410	360
340	45	160	420	370
350	45	165	430	380
360	45	170	450	400

**NOTES:**

- 1 Tie bars shall be spaced at 600mm centre to centre.
  - 2 Tie bars shall not be placed within 600mm of a transverse joint, longitudinal joint, or the edge of pavement.
  - 3 Holes shall be drilled perpendicular to the face of the longitudinal crack.
- A All dimensions are in millimetres unless otherwise shown.

**LEGEND:**

$\tau$  - Concrete pavement thickness

ONTARIO PROVINCIAL STANDARD DRAWING	Nov 2017	Rev 1	
<b>CONCRETE PAVEMENT AND CONCRETE BASE</b>		-----	
<b>CROSS-STITCHING LONGITUDINAL CRACKS</b>		<b>OPSD 560.025</b>	